



Control Hub1GoBilda5203
FTC -



DriverHub3

Robot Connected

Network: FTC-A3Qn
Ping: 4ms - ch 6

User 1 User 2

Practice Timer
2:30

2024

DS: 100%

12.68 V
(12.68 V)

Expansion Hub 2 was missing at startup. Robot Restart required for hub operation.

The Robot Controller and Driver Station app versions do not match, which is required for competition. You should update the Driver Station app.

Both the Robot Controller and Driver Station support 5 GHz. You should consider selecting a 5 GHz Wi-Fi channel.

Status : Robot is stopped

INIT

Configure Robot

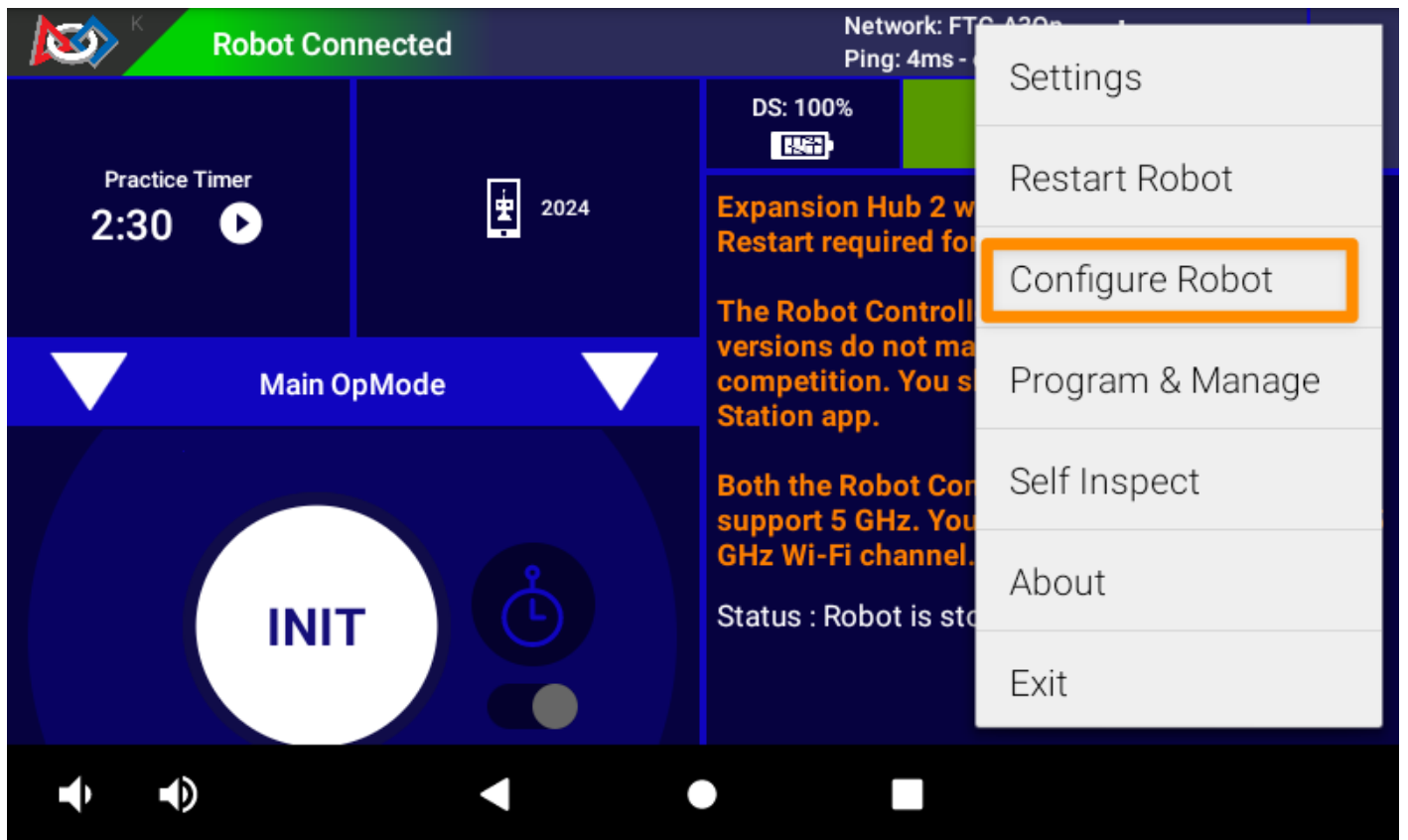

□New□□□□□□□□

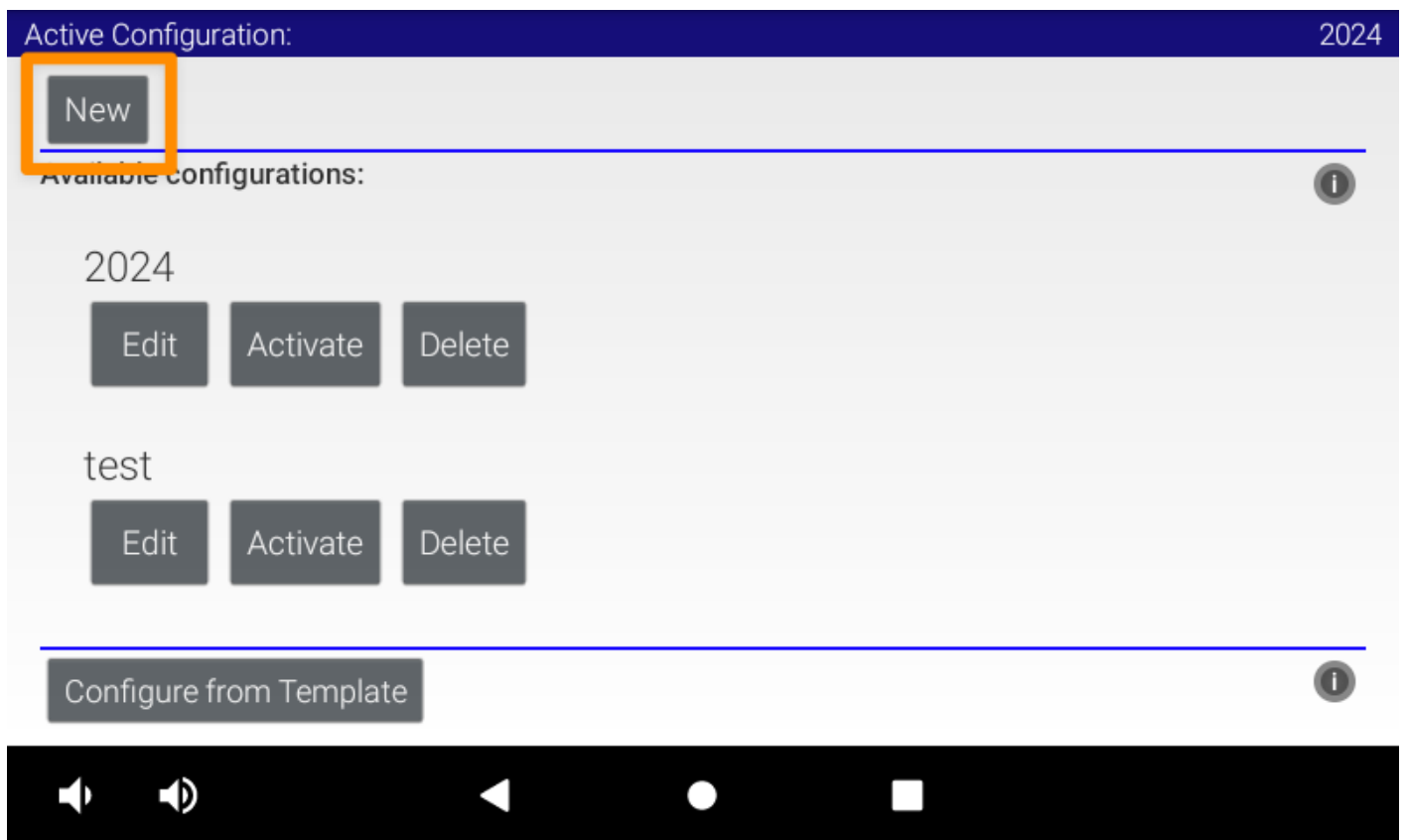

□Control Hub Portal□□□□□□□□

Save

Cancel

Scan



Press the 'Save' button to persistently save the current configuration

Press the 'Scan' button to rescan for attached devices

USB Devices in configuration:



Control Hub Portal

(embedded)

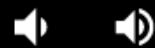

Control HubControl Hub

Done

Cancel

Control Hub Portal

(embedded)

Control Hub

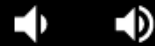

Motors

Active Configuration: (unsaved) <No Config Set>

Done Cancel

Control Hub

Motors

Servos

Digital Devices

Analog Input Devices

I2C Bus 0

GoBildaGoBILDA 5202/3/4 seriesmotor

Active Configuration: (unsaved) <No Config Set>

Done Cancel

Port	Attached
0	<div>GoBILDA 5202/3/4 series</div> <div>motor</div> <div>Motor name</div>
1	<div>Nothing</div>

NO DEVICE ATTACHED

DoneSave

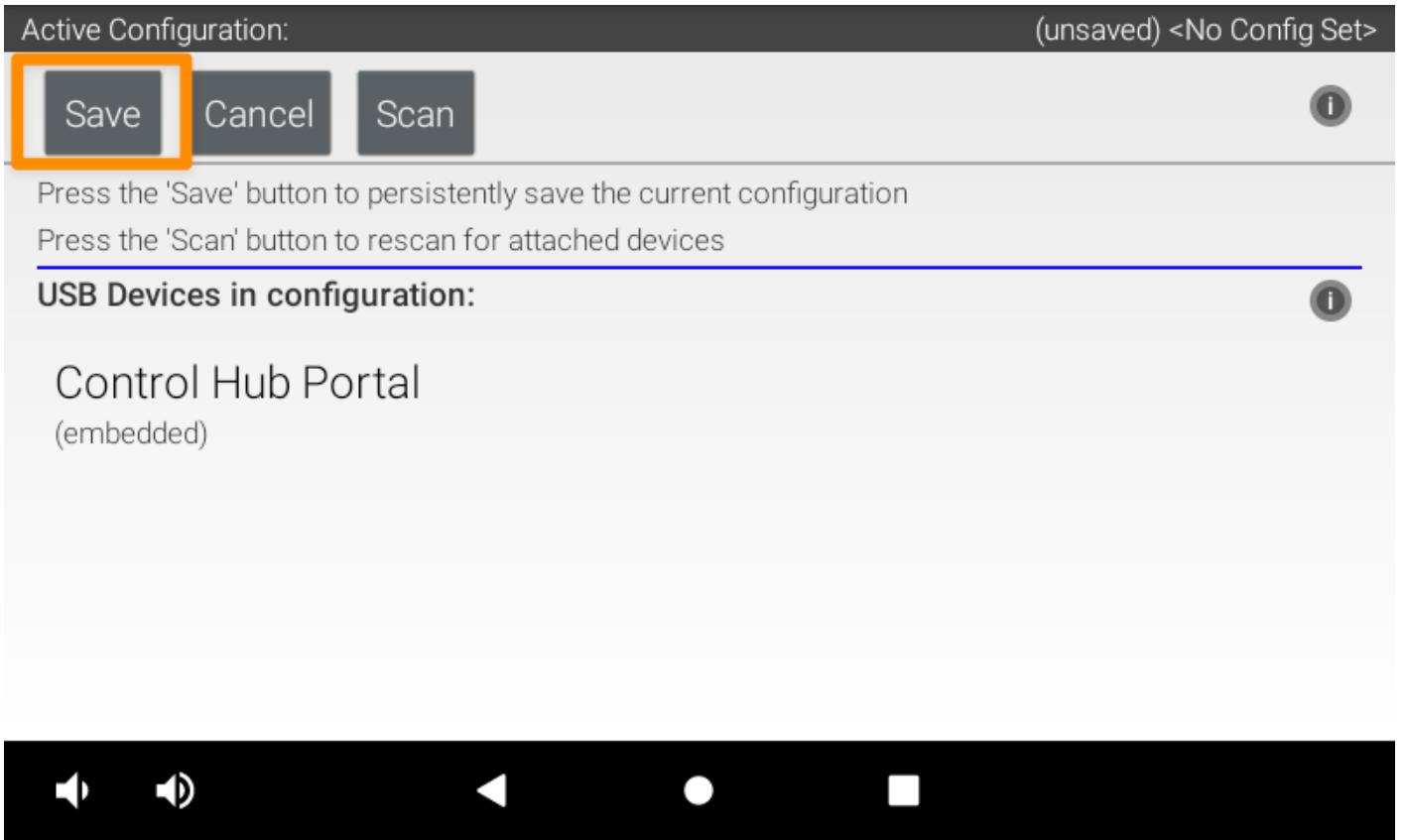

practice

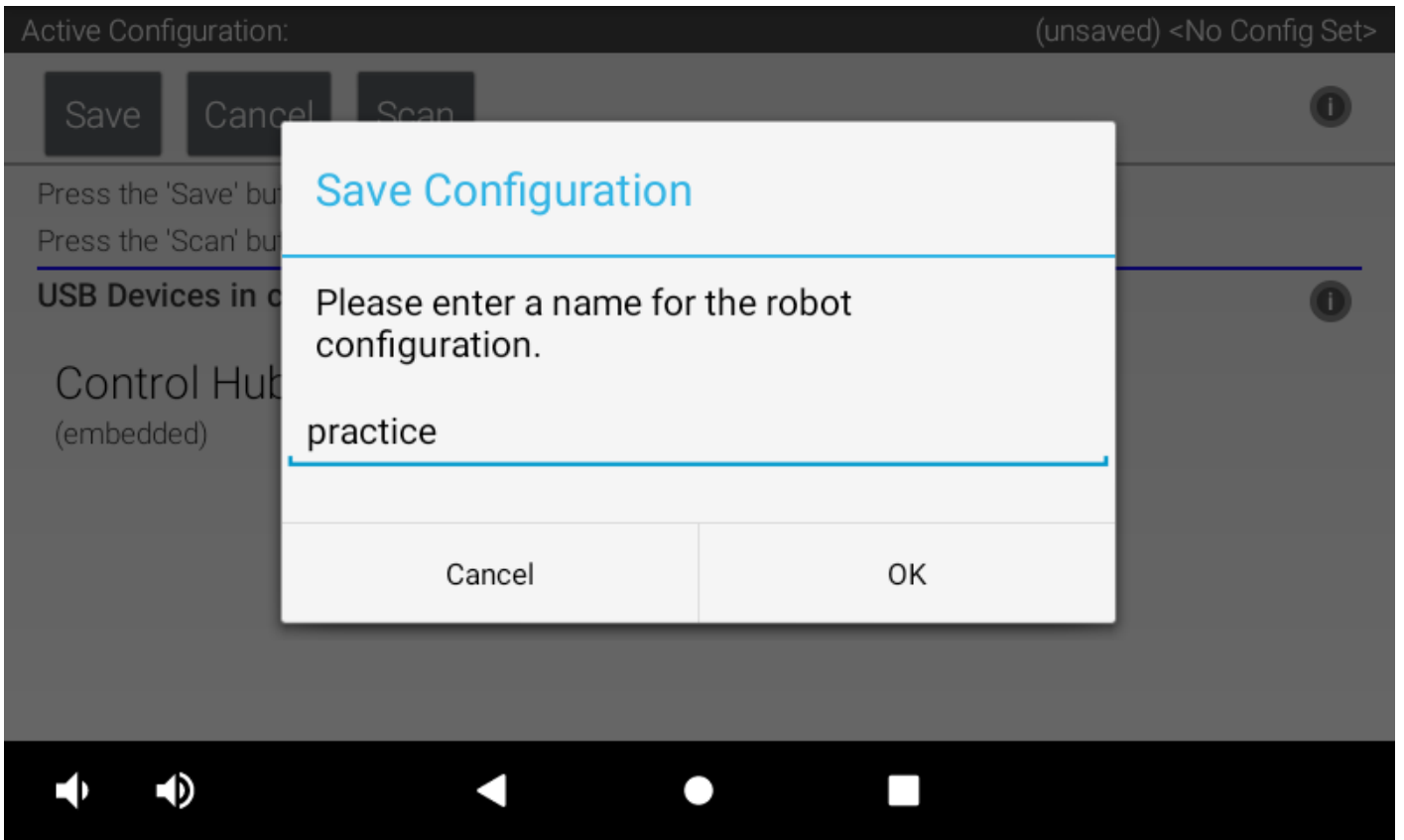

Activate

[New](#)Available configurations: 

practice

[Edit](#)[Activate](#)[Delete](#)

test

[Edit](#)[Activate](#)[Delete](#)[Configure from Template](#) 

Revision #2

Created 2 September 2024 09:58:37 by Yuki Terasaki / 23232

Updated 2 September 2024 10:18:17 by Yuki Terasaki / 23232